



NOTES:

B	FINAL AS BUILT DRAWINGS	G.G.U.B	G.C	AUG '13
A	ORIGINAL DRAWING	G.G.U.B	G.C	FEB '12
	REVISION	SURVEY	DRAWN	DATE

I, JAMES FRANCIS WELLER REGISTERED ENGINEER AND HOLDER OF AN ANNUAL REGISTRATION CERTIFICATE HEREBY CERTIFY THAT THIS PLAN IS CORRECT AND HAS BEEN PREPARED BY ME OR STAFF WORKING UNDER MY DIRECTION.

DATED THIS 11 DAY OF October 2013

[Signature]
 JAMES FRANCIS WELLER
 REGISTERED ENGINEER - IPENZ NUMBER 247951

COORDINATE DATUM
 GEODETIC 2000 - MT EDEN CIRCUIT
 ORIGIN OF COORDINATES
 SS 153 SO 49226 GEODETIC CODE BCVL
 810 667.526 mN 388 517.711 mE

LEVEL DATUM
 MEAN SEA LEVEL AUCKLAND 1946
 ORIGIN OF LEVELS
 SS 153 SO 49226 GEODETIC CODE BCVL
 STATED HEIGHT - 21.260m

	SURVEY DEPARTMENT
	FULTON HOGAN AUCKLAND
	RELIABLE WAY
	MOUNT WELLINGTON
	AUCKLAND
	PO BOX 11900
	ELLERSLIE 1051

WHENUAPAI AIRFIELD
 UPGRADE WORKS
 AS BUILT CONTOUR PLAN

NEW ZEALAND DEFENCE FORCE

SHEET 1 OF 2

SCALE (A1) - 1: 500
 SCALE (A3) - 1: 1000

DATE
 1 May 2012

FILE PATH G:\110 Construction\Survey\Jobs\Whenuapai Airfield 201314 (200888)
 \03-21 SEP PORTION 2\AS BUILT DATA\Final Asbuilt Drawings 22-3-12

DRAWING NUMBER
 Final earthworks topo18-04-2012GC

REVISION
 B

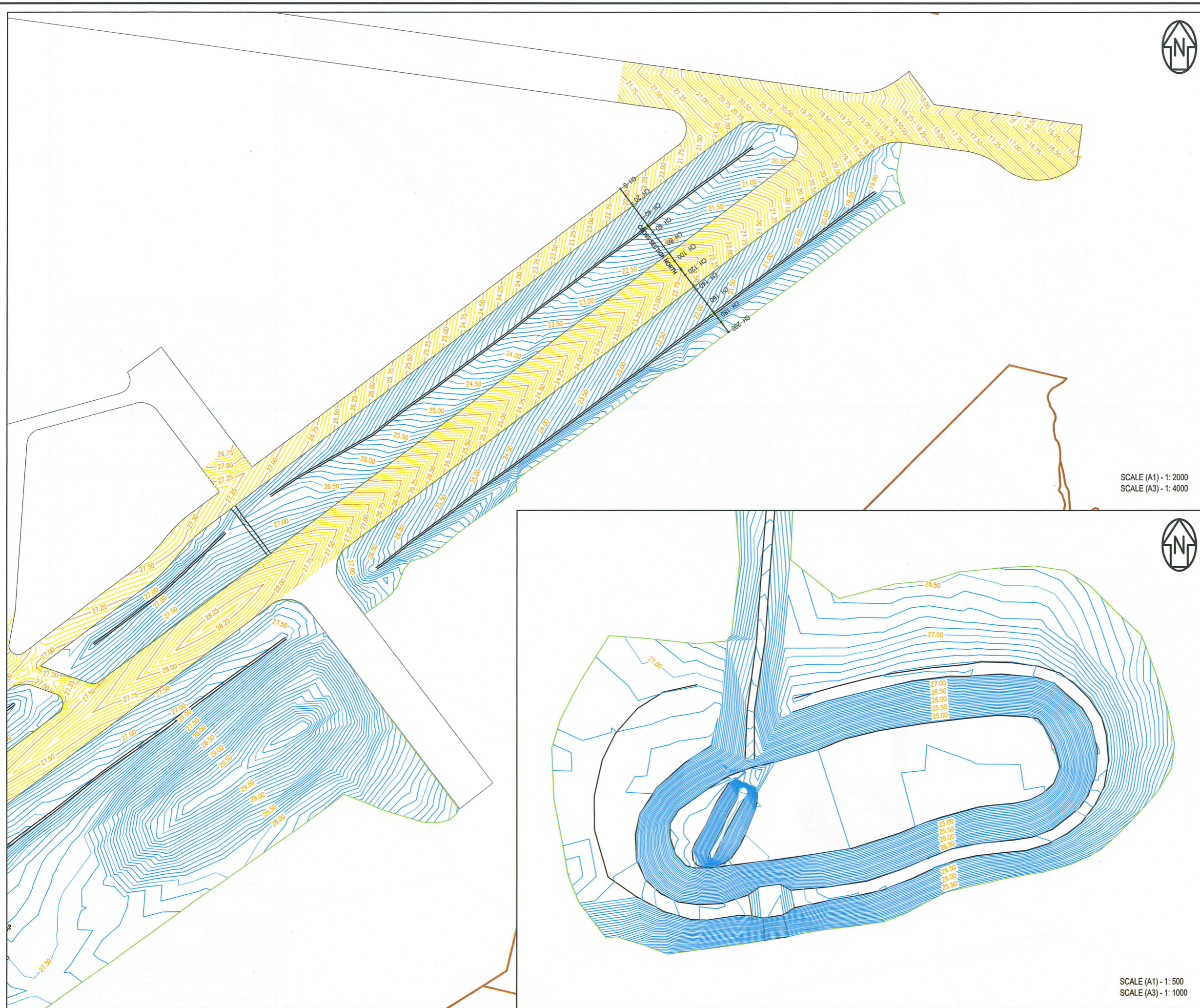

NOTES:

B	FINAL AS BUILT DRAWINGS	G.G.U.B	G.C	AUG'13
A	ORIGINAL DRAWING	G.G.U.B	G.C	FEB'12
	REVISION	SURVEY	DRAWN	DATE

I, JAMES FRANCIS WELLER REGISTERED ENGINEER AND HOLDER OF AN ANNUAL REGISTRATION CERTIFICATE HEREBY CERTIFY THAT THIS PLAN IS CORRECT AND HAS BEEN PREPARED BY ME OR STAFF WORKING UNDER MY DIRECTION.

DATED THIS 11 DAY OF October 2013

JAMES FRANCIS WELLER
REGISTERED ENGINEER - IPENZ NUMBER 247951

COORDINATE DATUM
GEODETTIC 2000 - MT EDEN CIRCUIT
ORIGIN OF COORDINATES
SS 153 SO 49226 GEODETTIC CODE BCVL
810 667.526 mN 388 517.711 mE

LEVEL DATUM
MEAN SEA LEVEL AUCKLAND 1946
ORIGIN OF LEVELS
SS 153 SO 49226 GEODETTIC CODE BCVL
STATED HEIGHT - 21.260m

Fulton Hogan SURVEY DEPARTMENT
FULTON HOGAN AUCKLAND
RELIABLE WAY
MOUNT WELLINGTON
AUCKLAND
PO BOX 11900
ELLERSLIE 1051

WHENUAPAI AIRFIELD
UPGRADE WORKS
AS BUILT CONTOUR PLAN

NEW ZEALAND DEFENCE FORCE

SHEET 2 OF 2

SCALE (A1) - AS SHOWN
SCALE (A3) - AS SHOWN
DATE
1 May 2012

FILE PATH
G:\10 Construction\Survey\Jobs\Whenuapai Airfield 2013\4 (200888)
103-21 SEP PORTION 2\AS BUILT DATA\Final Asbuilt Drawings 22-3-12

DRAWING NUMBER
Final earthworks topo18-04-2012GC
REVISION
B



SCALE - Hz 1: 500 Vert 1: 100

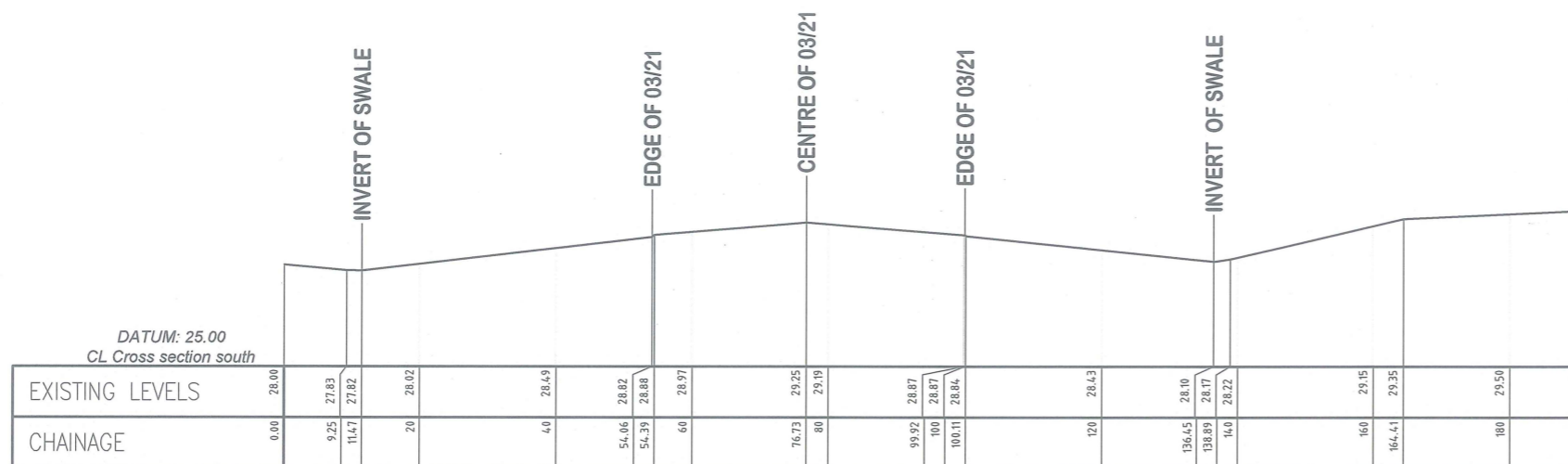

SCALE - Hz 1: 500 Vert 1: 100

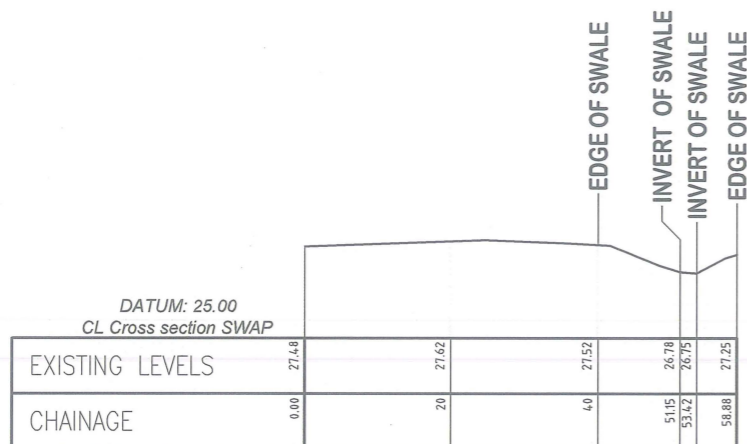

SCALE - Hz 1: 500 Vert 1: 100

NOTES:

B	FINAL AS BUILT DRAWINGS	G.G.J.B	G.C	AUG '13
A	ORIGINAL DRAWING	G.G.J.B	G.C	FEB '12
REVISION		SURVEY	DRAWN	DATE

I, JAMES FRANCIS WELLER REGISTERED ENGINEER AND HOLDER OF AN ANNUAL REGISTRATION CERTIFICATE HEREBY CERTIFY THAT THIS PLAN IS CORRECT AND HAS BEEN PREPARED BY ME OR STAFF WORKING UNDER MY DIRECTION.

DATED THIS 11 DAY OF October 2013

JAMES FRANCIS WELLER
REGISTERED ENGINEER - IPENZ NUMBER 247951

COORDINATE DATUM
GEODETTIC 2000 - MT EDEN CIRCUIT
ORIGIN OF COORDINATES
SS 153 SO 49226 GEODETTIC CODE BCVL
810 667.526 mN 388 517.711 mE

LEVEL DATUM
MEAN SEA LEVEL AUCKLAND 1946
ORIGIN OF LEVELS
SS 153 SO 49226 GEODETTIC CODE BCVL
STATED HEIGHT - 21.260m

SURVEY DEPARTMENT
FULTON HOGAN AUCKLAND
RELIABLE WAY
MOUNT WELLINGTON
AUCKLAND
PO BOX 11900
ELLERSLIE 1051

WHENUAPAI AIRFIELD
UPGRADE WORKS
CROSS SECTIONS

NEW ZEALAND DEFENCE FORCE

SHEET 1 OF 1

SCALE (A1) - AS SHOWN	DATE
SCALE (A3) - AS SHOWN	1 May 2012

FILE PATH G:\110 Construction\Survey\Jobs\Whenuapai Airfield 2014 (200888)
103-21 SEP PORTION 2AS BUILT DATA\Final Asbuilt Drawings 22-3-12

DRAWING NUMBER Final earthworks topo28-5-12GC RevA	REVISION B
---	---------------